



Seating and Accessory Catalogue

Issue 21

Blatchford 

Contents

Ordering Information	4
Safety Information	5
Assessment	6
Kato Seating System	8
Carved Foam Seat	10
Moulded Seat Insert	12
Seat Interfacing	14
General Bracketry	15
Head Supports	16
Head Rest Brackets	18
Chest Harnesses	20
Belts	22
Accessories	24
Foot Supports	26

A Passion for Posture

Blatchford is a leading global rehabilitation provider that designs and manufactures posture management seating.

With our passion for posture, Blatchford is at the forefront of Special Seating with custom and modular solutions designed to provide optimal postural support. The patients' needs are always at the heart of our designs and we continually seek to provide the very best custom seating, not only to support long-term health but also to offer accessible seating where we can see the user, rather than the seat. Our experienced team of clinicians and engineers understand the importance of sitting correctly and comfortably, especially for those who do not have the required postural control to achieve this on their own.



Ordering Information

1. Ordering:

Ordering products from Blatchford is simple and easy. You can contact our Customer Services directly:

Telephone: +44 (0) 114 2637900

Email: seatingcs@blatchford.co.uk

Facsimile: +44 (0) 114 2637901

Post: Blatchford Limited, 11 Atlas Way, Atlas North, Sheffield, S4 7QQ.

2. Delivery Promise:

Our goal is to provide a fast and efficient delivery. Therefore our aim is to despatch all orders for stock products, received by 2pm Monday to Thursday and by 11am on Fridays, on the day the order is received. This does not apply where specific delivery schedules have been previously agreed and is subject to stock availability.

3. Single Patient Use - Manufactured and stock

All products prescribed/distributed by Blatchford are for single patient use only and should be fitted by a qualified health care professional. The re-use of any product can potentially cause harm to the user and will invalidate the CE or any warranty agreement.

All user mass, activity levels and load bearing are stipulated according to the manufacturer's IFU.

4. Warranty

All products are covered by a manufacturer's warranty please refer to the product IFU or contact a member of our customer service team. All products supplied by Blatchford conform to MDD or MDR regulations.

5. Catalogues/Product Information:

If you require additional catalogues or product information please contact our customer service advisors who will be happy to help with your enquiry.

6. Shortages/Damaged Goods:

If any items are received damaged or there are shortages in the delivery this must be notified to customer services within 5 days of receipt of goods.

7. Returns:

In the unlikely event of any product being supplied faulty or having been incorrectly supplied, please contact customer services so that the correct or replacement goods may be despatched immediately and a collection arranged for the items to be returned. We are happy to accept 'stock products' that are returned for credit if they are not suitable for the patient. For items to be accepted for credit the following conditions apply:

- The product must not have been adapted in any way
- Are returned in the original packaging
- Are in a re-saleable condition

Blatchford reserves the right to reject items returned for credit if the above conditions are not met. Blatchford are unable to accept return of items that are 'made to order' for credit, unless the goods are faulty or it can be demonstrated they have been damaged in transit.

Please note items not stocked by Blatchford will be subject to the outside supplier lead-time.

Products & prices are subject to variation at any time and are subject to availability. E & OE.

8. Bespoke Custom Manufacturing Service

In addition to our accessory range, we also manufacture a wide range of fully bespoke solutions using the latest CAD-CAM technologies, to complement this we also use traditional hand skills. All our seating products are manufactured in the UK at our Central Seating manufacturing facility in Sheffield. Bespoke products include:

- MSI
- KATO
- Carve Foam
- Custom seat covers
- Seating Accessories

If you have any questions regarding the products in this brochure please contact Customer Services on +44 (0) 114 2637900 or alternatively email seatingcs@blatchford.co.uk

Safety Information

We distribute a range of posture belts and harnesses which are designed to provide postural support and can be used as part of a specialised seating system or standard wheelchair seating. The range of harnesses and belts are not designed to be used as safety devices and must not be used as vehicle restraints for use in transportation. A separate passenger restraint should always be used in line with the recommendation of the wheelchair manufacturer.

A suitable, separate 3 point passenger seat belt (fastened into a vehicle) must be used to secure the seated occupant during travel in line with the recommendation of the wheelchair manufacturer.

Always ensure that all pelvic belts and harnesses are a snug fit, hold the client securely and are comfortable.

Upper body harnesses should always be fastened around the body. Always allow enough space between the neck and harness to ensure it does not pose a choking risk.

Where an upper body harness is being used, always use in conjunction with a pelvic belt which has been correctly adjusted to minimise the risk of sliding down in the seat, creating a choking risk.

Cleaning:

Postural belts and harnesses must be cleaned regularly by wiping with a damp cloth and a mild detergent (please do not use bleach or products containing bleach). If using a washing machine we recommend that the temperature is set to 40°C and they are not tumble dried.

Assessment



Assessment

1. Assessments are carried out by a Blatchford clinical seating engineer, who is allocated to your service, in partnership with the local seating clinician.
2. The assessment appointment is conducted with the user, carers and key therapists, enabling clinical and functional goals to be set.
3. An evaluation is carried out, ensuring the physical requirements for the seat are understood.
4. After the physical evaluation, measurements are taken and/or a mould is scanned of the desired seated position.
5. You will then receive a quotation/order verification for your approval.

Training is available for services wishing to carry out their own assessments.



Manufacturing

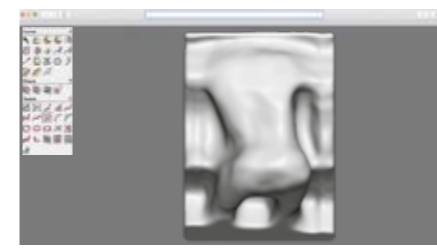

6. Measurements and/or seat scans are sent to our manufacturing facility for production.
7. The clinical seating engineer and production team are in contact to ensure the seat is produced to the exact requirements of the user.
8. The seat is finished using the upholstery and colours selected by the user, and if required, fitted into the selected wheelbase.



Delivery

9. At the appointment, final adjustments are made to the seat to ensure optimal fit. The carers and therapists present at the assessment are asked to be present at delivery, as this enables everyone to evaluate how well the user's goals have been met.
10. Key features of the seat and wheelchair are demonstrated to the user and carers, to ensure they are confident in using the new equipment.
11. Instructions for use are given to the user, so that they have information on their new seat to take home with them.



Working in Partnership

We consider the individual postural requirements and lifestyle needs of the user ensuring we understand the requirements of the seat. This process leads to the most appropriate personalised seating solutions.



Kato Seating System



Features

- Easily interfaced into commonly used wheelbases*
- Swing away lateral supports
- Medial thigh support (pommel)
- Built in lateral thigh supports with growth pads
- Up to 7.5cm seat depth adjustment
- Up to 5cm back height and seat width adjustment
- Platilon® liner
- Durable vinyl covers
- Available as a seat or back only
- Leg length, head support, harness and belt options

Description

The Blatchford Kato Seating System is a made to measure modular seating system, designed to provide durable postural support. It is made from detailed measurements taken during the clinic assessment, and can include features such as leg length discrepancies.

The seat is made from high density, high resilience polyurethane foam and a polypropylene shell to provide posterior support, strength and durability. Other specialist materials such as viscoelastic foams can also be included for increased pressure redistribution, where required.

The highly durable vinyl covers, which can be easily wiped clean, are available in a range of colours. Other cover options are available.

Training is available for services wishing to carry out their own assessments.



Removable hip pads for quick width adjustment



Change to hinged folding back option

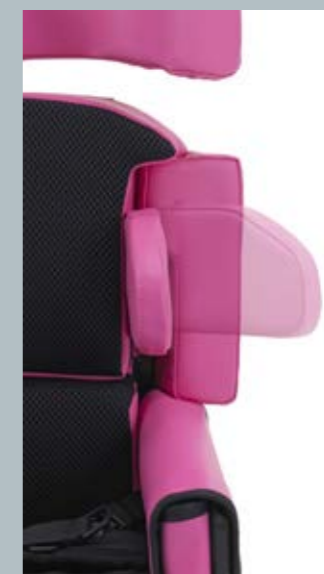

Swing away lateral supports



Hardwearing vinyl covers in a range of colours

Clinical Applications

The system is suitable for:

- ✓ Children and young adults
- ✓ Postural correction and accommodation
- ✓ Pressure redistribution
- ✓ Leg length discrepancy accommodation
- ✓ Moderate levels of tone
- ✓ Growth adjustment
- ✓ Use as a seat in transportation*

Kato Seating System – Crash tested to ISO 7176-19:2008

*Kato has been designed to be interfaced with most wheelbases. Kato can be used as a seat in transportation when combined with a crash tested wheelbase.

Kato Seating System

Description	Product Code
Kato Seat Hip Width up to 200mm	NSS010
Kato Seat Hip Width up to 300mm	NSS011
Kato Seat Hip Width above 300mm	NSS012
Half Kato up to 200mm	NSS722
Half Kato up to 300mm	NSS723
Half Kato above 300mm	NSS724

Kato Seating System Accessories

Description	Product Code
Base Cushion	NSS044
Recover Kato in Vinyl or Fabric	NSS229
Shaped Kato Back Pad	NSS041
Sacral/Lumbar Pad	NSS043
Pommel c/w bracket	NSS047
Knee Blocks c/w bracket	NSS051
Anti- thrust cushion - upgrade	NSS048
Seat Hinges (Pack of 2)	NSS255
Kato Headrest and Back Bar Bracket	NSS550
Left Swing Away Thoracic Bracket	NSS552
Right Swing Away Thoracic Bracket	NSS553

Carved Foam Seat



Features

- Several foam density options
- Easily interfaced into commonly used wheelbases*
- Carved using advanced technology to provide an accurate shape
- Platilon® liner for foam protection
- Head support, harness and posture belt choices
- Bespoke removable quilted covers, machine washable at 40 degrees

Description

The Blatchford Carved Foam Seat is designed to provide custom postural support. It is made using a 3D scan obtained during the clinic to ensure an accurate replication of the moulded shape.

High density, high reliance polyurethane foam is used to manufacture the seat. The foam has excellent immersion and envelopment properties providing additional pressure redistribution, as well as durability. The foam can be reinforced in certain areas using higher density foam to maximise support. The seat foam is then braced by a Polypropylene shell to support the foam posteriorly and laterally. The foam is covered in a protective Platilon® liner, which has excellent stretch qualities ensuring durability of the foam is maintained. It is also transparent, making it easy to regularly inspect the foam underneath.

Every seat/back support comes with a quilted Terry Towelling cover made to the colour choice combination of the customer, manufactured from a pattern, created individually to match the unique shape of every seat. Customers can upgrade to a Spacer material cover and choose from a selection of colour options. Waterproof covers made from Dartex® material are also available.

Back and seat only options are also available, allowing carved foam to be used in conjunction with other seating solutions.



7 Axis robot carved high density HR foam



Quilted cover in a range of colours

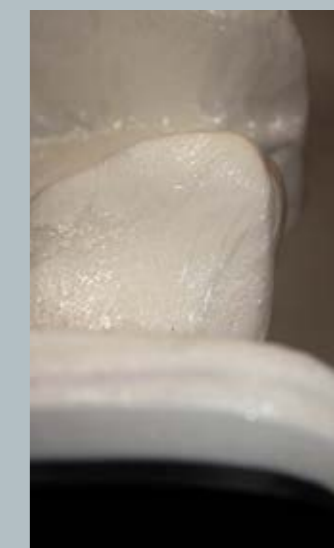

Platilon® liner

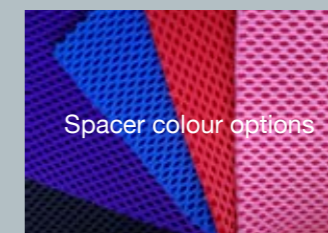

Spacer colour options

Clinical Applications

The system is suitable for:

- ✓ All ages
- ✓ Postural correction and accommodation
- ✓ Pressure redistribution
- ✓ Low to high tone
- ✓ Uncontrolled movements
- ✓ Microclimate control

*Seat – Crash tested to ISO 16840-4:2009(E)

*Carved Foam Seat has been designed to be interfaced with most wheelbases. Carved Foam Seat can be used as a seat in transportation when combined with a crash tested wheelbase.

Carved Foam Seat

Description	Product Code
Carved Foam Backrest	NSS527
Carved Foam Base Cushion	NSS528

Carved Foam Seat Accessories

Description	Product Code
Replacement Cover Backrest/Base Cushion (Terry Towelling, Spacer or Dartex)	NSS537
One Piece Polypropylene Shell Surcharge	810103
Polyprop Shell for Backrest and Base Insert	NSS530

Moulded Seat Insert



Features

- Easily interfaced into commonly used wheelbases*
- Hand crafted to provide optimum support and posture correction
- Lightweight and strong design
- Optional quilted covers for pressure redistribution
- Head support, harness and posture belt options
- Hightone
- Bespoke removable quilted covers, machine washable at 40 degrees
- Soft spots for pressure redistribution

Clinical Applications

The system is suitable for:

- ✓ All ages
- ✓ Postural correction
- ✓ Postural accommodation
- ✓ Pressure redistribution
- ✓ High tone
- ✓ Microclimate control (optional upgrade)
- ✓ Use as a seat in transportation*

Moulded Seat insert – Crash tested to ISO 16840-4:2009(E)
 *Moulded Seat Insert has been designed to be interfaced with most wheelbases. Moulded Seat Insert can be used as a seat in transportation when combined with a crash tested wheelbase.

Description

The Blatchford Moulded Seat Insert is designed to provide rigid custom postural support. It is made using a 3D scan and is moulded by hand to ensure every contour of the moulded shape is accurately replicated.

High density polyethylene (HDPE) is used to manufacture the seat shell, selected for its high strength to density ratio and resistance to stress cracks. The shell is surrounded by an undrilled support frame, for additional support and strength. This combination makes it resistant to damage by even the most demanding users.

An integral liner is provided as standard. Additional removable liners can be used to maximise comfort and allows minor size adjustments, e.g. for growth.

Customers can add a cover from a selection of materials (Quilted Terry Towelling, Spacer or waterproof Dartex® material).



Hand crafted seat shell



Undrilled support frame



Removable liners for growth

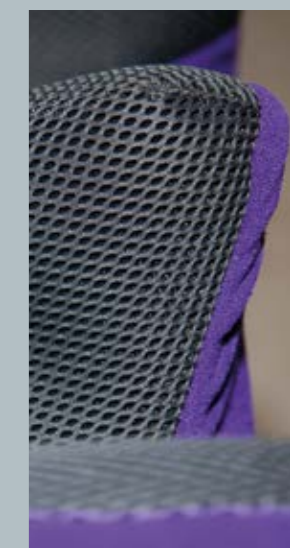

Spacer cover available in a range of colours

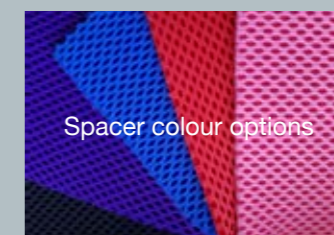

Spacer colour options

Moulded Seat Insert

Description	Product Code
Full MSI Framed Shell	NSS055
Half MSI	819022
Full MSI Shell (Manufacture Only)	NSS121
Half MSI Shell (Manufacture Only)	NSS122

Moulded Seat Insert Accessories

Description	Product Code
Padded Cover (Terry Towelling)	NSS115
Non-padded Cover	NSS906
Removable Pommel	NSS047
Removable Liner	NSS061
MSI Ventilate	NSS065
Additional Charge For Steel Frame	NSS064
Rear Bar with Locators	NSS005

Blatchford Adaptive Interface System (BAIS)



BAIS 2nd Interface - Fixed Frame
NSS701

Product Code NSS700 consists of both NSS701 and NSS717



BAIS Interface Removable Section Kit
NSS717

- To fit wheelchair widths 36cm to 58cm
- 4 different end sections enable BAIS 2nd Interface - Fixed Frame (NSS700) to attach to various wheel base systems. Product Code NSS700 consists of both NSS701 and NSS717. Please specify option A, B, C or D when ordering:



A
Folding End Section



B
Spectra Plus End Section



C
Spectra XTR End Section



D
Fixed End Section

Blatchford Adaptive Interface System (BAIS)

Description	Product Code
BAIS Interface - Fixed Frame	NSS700
BAIS 2nd Interface - Fixed Frame	NSS701
BAIS Interface - Folding Frame	NSS702
BAIS 2nd Interface - Folding Frame	NSS703
BAIS Interface for MSI - Fixed Frame	NSS704
BAIS Conversion Kit (To Folding Chair)	NSS708
BAIS Conversion Kit (To Fixed Chair)	NSS709
BAIS Interface Removable Section Kit	NSS717

General Bracketry (shown on opposite page)

General Brackets

Description	Product Code
Non Standard Bracket Surcharge	NSS009
Pommel and Knee Block Location Bracket	NSS204
Footplate Depth Stopper	NSS208
Vertical Footrest Bracket	NSS209
No.2 Footrest Location Bracket	NSS210
Seat Hinges (Pack of 2)	NSS255
Kato Headrest and Back Bar Bracket	NSS550
Left Swing Away Thoracic Bracket	NSS552
Right Swing Away Thoracic Bracket	NSS553
Pommel and Kneeblock Attachment Bracket	NSS555
Pommel Bracket	NSS556
Kneeblock Central Mounting Bracket	NSS557
FootBox/Footboard Bracket	NSS560
Triple Foot and Knee Medial Thigh Support Bracket	23072

General Bracketry



Pommel and Knee Block Location Bracket
NSS204



Footplate Depth Stopper
NSS208



Vertical Footrest Bracket
NSS209



No.2 Footrest Location Bracket
NSS210



Seat Hinges (Pack of 2)
NSS255



Kato Headrest and Back Bar Bracket
NSS550



Left Swing Away Thoracic Bracket
NSS552



Right Swing Away Thoracic Bracket
NSS553

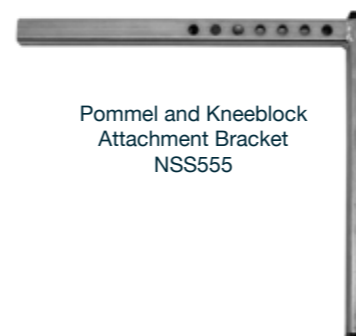

Pommel and Kneeblock Attachment Bracket
NSS555



Pommel Bracket
NSS556



Kneeblock Central Mounting Bracket
NSS557



Footbox/Footboard Bracket
NSS560



Triple Foot and Knee Medial Thigh Support Bracket
23072

K1 and K2 Head Supports

- Basic flat head support
- Comes with hinged bracket
- Width 240mm
- Available with Vinyl, Dartex®, Spacer or Terry Towelling covers

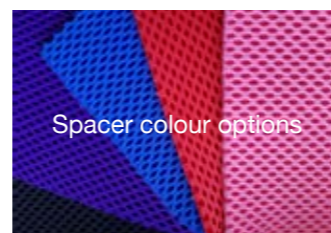

K1 and K2 Head Supports

Description	Height (mm)	Product Code
Adjustable Basic Headrest K1	130	NSS170
Adjustable Basic Headrest K2	180	NSS170

Custom Made Curved Head Support

- Basic curved head support
- Comes with hinged bracket
- Can update to a ball joint fixing
- Select width and height
- Available with Vinyl, Dartex®, Spacer or Terry Towelling covers

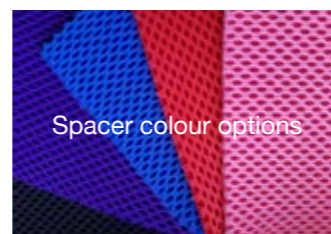

Custom Made Curved Head Support

Description	Product Code
Custom Made Curved Headrest c/w cover	NSS172

Custom Made Curved Head Support Accessories

Description	Product Code
Headrest Cover	NSS220

Standard Curved Headrest

- Shaped headrest providing good comfort combined with minimal positioning

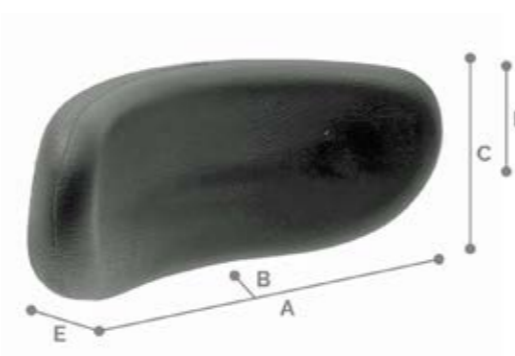

Standard Curved Headrest

Product Code	Size	Measurements (mm)				
		A	B	C	D	E
NSS171	Small	195	50	100	60	30
NSS171-2	Large	300	75	150	90	45

Anti-Roll Headrest

- Available in shallow and deep
- Comes hinged but can be upgraded to ball joint fixing
- Shallow Curve Depth 50mm
- Deep Curve Depth 100mm



Anti-Roll Headrest

Description	Product Code
Anti-Roll Headrest c/w cover	NSS087
Ball Joint Fixing	NSS211

Headrest Fixtures

- A variety of mounting applications are available for headrests, as shown below
- 13mm square chrome
- Comes with height adjustment collar, four point fixing and headrest mounting plate
- Available in straight stem (300mm tall) and crank stem (340mm) tall



A Standard Mount



C Angle Adjustable



D Multi-axis Straight Stem

Headrest Fixtures

Description	Product Code
Standard Mount	A - L8-P01-F3-B
Angle Adjustable	C - L8-P36-F3
Multi-axis Straight Stem	D - L8-P37-F3

Kato Thoracic Pads

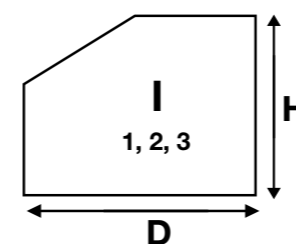

Kato Thoracic Pads

Product Code	Size*	Measurements (mm)	
		Height	Depth
NSS042	1	80	110
NSS042	2	100	140
NSS042	3	150	180

*Please specify the correct size at the point of ordering.

4 Point Fixing Headrest Mount 13mm

4 Point Fixing Headrest Mount 13mm
Product Code
 L3-P05-F3-A



Specialist Seating Mount

- Mounting plate allows fitting to a backrest shell or channel back system (e.g. Vtrak)
- Suitable for both 13mm and 16mm headrest stems
- Tapered mount allows the headrest stem to be used in one unit
- Centre thumbscrew to hold headrest stem without marking corner edges of stem

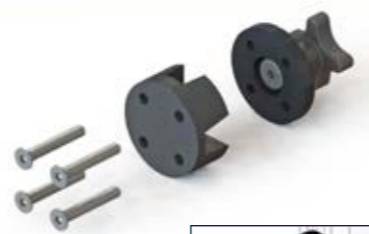

Specialist Seating Mount
Product Code
 L4-P44-SSHM-BL

Ball Mount with Collar 300mm

- 13mm square chrome bracketry
- Comes with stainless steel mounting collar



Ball Mount with Collar 300mm
Product Code
 NSS211

Height Adjustment Collar

Height Adjustment Collar
Product Code
 L8-P08-F3-BL



90 Degree Stem 300mm

- 13mm square chrome bracketry
- Comes with tri-knob



90 Degree Stem 300mm
Product Code
 NSS201

Swan Neck Stem 300mm

- 13mm square chrome bracketry
- Comes with tri-knob



Swan Neck Stem 300mm
Product Code
 L8-P04-F3-A-BL

Lock and Latch Fittings

- Designed by RMS, the innovative Lock and Latch System enables drop-in seats and backrests to be quickly and securely attached to most standard wheelchair frames
- The latch mounting is made for retaining the seat drop in hooks in position on a wheelchair frame
- Equipped with a simple push/pull slide action locking pin, designed with strength, ease of use and durability in mind
- The lock mounting offers a solid, fixed receiver for lower backrest brackets or rear seat base drop-hooks, with the system successfully crash tested to ISO 16840-4
- Available in standard sets of two locks and two latches
- All sizes and types are available in single items



Lock and Latch Fittings	
Description	Product Code
2 Lock and 2 latches to suit 19mm tubing	LL19-BL
2 Lock and 2 latches to suit 22mm tubing	LL22-BL
2 Lock and 2 latches to suit 25mm tubing	LL25-BL

Dynamic Harness

- Designed to offer high levels of support and comfort whilst also limiting the amount of user movement



Dynamic Harness		Measurements (mm)			
Product Code	Size	A	B	C	D
H009-BL	Small	110	180	160	45
H010-BL	Medium	145	230	200	50
H011-BL	Large	175	260	230	60

Sternum Harness

- The chest pad offers greater support with the users weight distributed even throughout the harness



Sternum Harness		Measurements (mm)				
Product Code	Size	A	B	C	D	E
H012-BL	Small	270	225	130	60	130
H004-BL	Medium	330	255	155	60	150
H005-BL	Large	460	260	200	60	200

Shoulder Harness

- Pads are designed to distribute pressure evenly over the chest and shoulders
- Quick release buckle



Shoulder Harness		Measurements (mm)		
Product Code	Size	A	B	C
H006-BL	Small	300	95	45
H007-BL	Medium	330	115	65
H008-BL	Large	430	145	75

Slimline Sternum Harness

- Shaped to give greater flexibility in client fitting while still providing excellent postural support



Slimline Sternum Harness		Measurements (mm)				
Product Code	Size	A	B	C	D	E
H014-BL	Small	360	230	170	30	140
H015-BL	Medium	420	250	190	30	160
H016-BL	Large	470	260	200	30	180

Gel Wrap Around Sheath

- A custom gel wrap
- Can be manufactured to fit different sized belts - please specify the following dimensions when ordering:
Length x Width



Gel Wrap Around Sheath
Product Code
NSS923

Two Point Single Pull Metal Buckle Belt



Two Point Single Pull Metal Buckle Belt

Description	Product Code	Size	Overall Length	Webbing
Two Point Single Pull Metal Buckle Belt	BMB-001-S	Small	310mm	25mm
Two Point Single Pull Metal Buckle Belt	BMB-001-M	Medium	340mm	40mm
Two Point Single Pull Metal Buckle Belt	BMB-001-L	Large	460mm	40mm

Four Point Dual Pull Plastic Buckle Belt



Four Point Dual Pull Plastic Buckle Belt

Description	Product Code	Size	Overall Length	Webbing
Four Point Dual Pull Plastic Buckle Belt	BPB-005-S	Small	310mm	25mm
Four Point Dual Pull Plastic Buckle Belt	BPB-005-M	Medium	340mm	40mm
Four Point Dual Pull Plastic Buckle Belt	BPB-005-L	Large	460mm	40mm

Four Point Single Pull Metal Buckle Belt



Four Point Single Pull Metal Buckle Belt

Description	Product Code	Size	Overall Length	Webbing
Four Point Single Pull Metal Buckle Belt	BMB-002-S	Small	310mm	25mm
Four Point Single Pull Metal Buckle Belt	BMB-002-M	Medium	340mm	40mm
Four Point Single Pull Metal Buckle Belt	BMB-002-L	Large	460mm	40mm

Pelvic Stabiliser Single Pull Metal Buckle



Pelvic Stabiliser Single Pull Metal Buckle

Description	Product Code	Size	Overall Length	Webbing
Pelvic Stabiliser Single Pull Metal Buckle	BMB-004-S	Small	340mm	25mm
Pelvic Stabiliser Single Pull Metal Buckle	BMB-004-M	Medium	420mm	40mm
Pelvic Stabiliser Single Pull Metal Buckle	BMB-004-L	Large	430mm	40mm

Two Point Dual Pull Plastic Buckle Belt



Two Point Dual Pull Plastic Buckle Belt

Description	Product Code	Size	Overall Length	Webbing
Two Point Dual Pull Plastic Buckle Belt	BPB-004-S	Small	310mm	25mm
Two Point Dual Pull Plastic Buckle Belt	BPB-004-M	Medium	340mm	40mm
Two Point Dual Pull Plastic Buckle Belt	BPB-004-L	Large	460mm	40mm

Moulded Trays



Moulded Trays		
Description	Size	Product Code
Moulded Tray including Brackets	Small tray size 1/2 rim	NSS192
Moulded Tray including Brackets	Large	NSS193
Tray Insert Vinyl Covered		NSS194



Moulded Sandals

- Moulded foot supports can assist in achieving the desired seating position or to offer a greater level of control for the feet
- Supports can be located in any position on the wheelchair footrest
- Each support is fitted with soft 25mm nylon webbing toe and instep straps as standard, which are easily adjusted and controlled through a quick release buckle



Moulded Sandals

Size	A	B	C	Product Code
2	80	90	210	NSS903
3	85	100	245	NSS904
4	100	120	280	NSS905

Anklesures

- Positive, discreet and easily adjustable
- Secures the ankle whilst allowing the foot to move naturally, retaining a level of freedom without losing position
- Available in five sizes from extra small with a circumference of 155 mm, up to extra large with a circumference of 350 mm
- Hook and loop or side release plastic buckle closures available
- Supplied with fitting kit and all fixtures as standard
- Compatible system with most wheelchair footboards or footplates



Anklesures

Size	Circumference (mm)	Product Code - Buckle Closure	Product Code - Hook and Loop Closure
Extra Small	155 - 200	AS001	AS001B
Small	160 - 215	AS002	AS002B
Medium	175 - 230	AS003	AS003B
Large	240 - 295	AS004	AS004B
Extra Large	295 - 350	AS005	AS005B

Footbox/Footboard



Standard Footbox Attached to Seat Special Footbox (top and bottom view) includes black footbox/footboard bracket, chrome footbox stems and stop collars. The interface fixings can be double bracket mount (fixed to BAIS) or using the triple bracket mount (fixed to seating system).

Footbox Insert Vinyl Covered

Standard Footbox/ Footboard Measurements (mm)

Size	W	X	Y
1	260	75	175
2	300	75	225
3	375	75	300

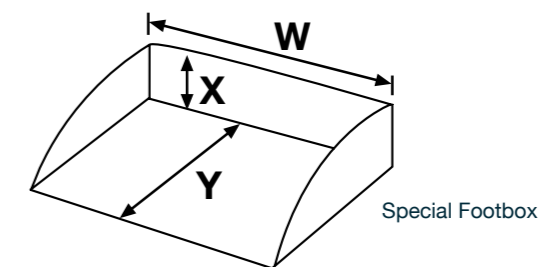

Special Footbox

Footbox/Footboard

Description	Product Code
Footbox Attached to Seat (Adjustable)	NSS060
Special Footbox	NSS715

Footbox/Footboard Plastic Only

Size	Product Code
1/Small	NSS268
2/Medium	NSS269
3/Large	NSS270

Footbox/Footboard Accessories

Description	Product Code
Footbox Insert Vinyl Covered	NSS091
NSS100 Footbox Raise	NSS100
NSS072 Foot Straps (Pair)	NSS072

Foot Box Pads

- Soft crumb foam
- When requesting your footbox you can order different depths of soft crumb padding: 50mm, 75mm or 100mm. These can also be ordered separately if required.



Top view



Bottom view

Footbox Pads

Size	Product Code
1	NSS831
2	NSS832
3	NSS833

+44 (0) 114 263 7900 | seatingcs@blatchford.co.uk
Blatchford Limited, 30 Atlas Way, Sheffield, S4 7QQ, United Kingdom.

@blatchfordgrp | blatchfordmobility.com

1454992327 Iss3 02/24. Information correct at time of print.

Blatchford 